

**CENTRAL MAINE POWER COMPANY
RESPONSE TO ORAL DATA REQUEST NO. 2
DOCKET No. 2008-255**

November 21, 2008

ODR-02-07

Q. Please provide a copy of data sheets from the historical and environmental surveys conducted near the Henderson's home in Dixmont.

A. The appropriate data sheets are attached.

Response Prepared & Submitted By:

David Dominie
Senior Environmental Specialist
TRC Companies, Inc.

Attachments:

1. Resource Map
2. Environmental Survey Data Sheets



<p>MPRP Project Data</p> <ul style="list-style-type: none"> MPRP Substation MPRP Project Limits 1 Pole Structure 2 Pole Structure 3 Pole Structure MPRP Section Centerline MPRP Segment Label MPRP Section Label 	<p>Base Data (ME OGIS)</p> <ul style="list-style-type: none"> NWI Wetland Feature Hydrography Intermittent Stream Perennial Stream State Boundary County Boundary Town Boundary 	<p>Existing CMP Infrastructure</p> <ul style="list-style-type: none"> 34.5 kV Transmission Line 115 kV Transmission Line 345 kV Transmission Line Existing 34.5 kV Section Label Existing 115 kV Section Label Existing 345 kV Section Label 	<p>Sensitive Areas as Surveyed by TRC</p> <ul style="list-style-type: none"> Stream (Identified by TRC) Wetland (Identified by TRC) Rare Plants Survey Results: 2007 Survey Significant Vernal Pool Natural Vernal Pool Amphibian Breeding Area 	<p>Sensitive Areas from Maine IF&W</p> <ul style="list-style-type: none"> Wading Bird Occurrence Bald Eagle Habitat Deer Wintering Area RTE Species Identified in area Significant Shorebird Habitat Waterfowl Wading Bird Habitat <p>Sensitive Areas from Maine Natural Areas Program</p> <ul style="list-style-type: none"> MNAP-Rare Plant Community or Element Occurrence 	<p>Note: All items shown in the legend may not appear in the map extent.</p>  <p>MAINE POWER RELIABILITY PROGRAM A CENTRAL MAINE POWER COMPANY PROGRAM</p> <p>CONFIDENTIAL MATERIAL: PURSUANT TO MPUC RULES, CHAPTER 140</p>
---	--	---	--	---	---

Source: Maine Office of GIS, Central Maine Power Co., TRC, Maine IF&W, Maine MNAP

Maine Power Reliability Project

Team A

WETLAND SUMMARY FORM

Observers: CCP, DWP, KIW Date: 8-22-07
 Town: DIXMONT Series: 1-28-17
 Segment #: 3 CMP Section #: 203 CMP Pole #: 196 Wetland ID #: 1
 Stream/Waterbody ID: A3-203-196-1-CH1 Corps plot: Yes No
 Dominant NWI Class: PSS1 Other NWI Classes: fem1

Representative Wetland Vegetation (by Strata): SHRUB: HERB:
Alnus inc. Cal. can.
Cornus stolon. Eup. macul.
Vib. racem. Gly. grandis
Ilex vert. Onoc. sens.

Representative Wetland Hydrology

Permanently Flooded (approximate depth -) Seasonally Flooded (approximate depth -) Saturated

Hydrologic Indicators: Silt Deposition Water-Stained Leaves
 Water Marks Drift Lines Surface Scouring
 Drainage Patterns Buttressed Trees Elevated Roots

Other Observations: HILLSIDE SLOPES/ERODED PASTURE

Representative Wetland Soils:
 Mineral
 Organic

Depth	Horizon	Color	Redox Features	Texture
0-12"	Ap	10YR 3/2	φ	L
12-22"	Bg	10YR 4/2	E, F, D	SL, 15% CR
22-27"				
27" +	C	2.5Y 5/3	C, M, F	↓

Other Observations: Meets NEIWPCC (2004) Criteria VII Monarda loam

Stream # 1 Data:
 Width (Bank-Bank): 4 ft. Depth @ Center: 3 in. Peren. Intermittent
 Bank Configuration: Undercut Vertical Gradual
 Channel Substrate: Peat-Muck Silt-Mud Sand Gravel/Cobble Boulder
 Bedrock

Stream # 2 Data:
 Width (Bank-Bank): _____ Depth @ Center: _____ Peren. _____ Intermittent _____
 Bank Configuration: _____ Undercut _____ Vertical _____ Gradual _____
 Channel Substrate: _____ Peat-Muck _____ Silt-Mud _____ Sand _____ Gravel/Cobble _____ Boulder
 Bedrock

Wildlife Observations/Signs (e.g., tracks/trails, droppings, dams/lodges, browse, dens, egg masses, potential VP):

Notes: NRPA STREAM WITH ASSOCIATED WETLAND.

Cedar Swamp

Wetland of Special Significance

Photo # 1

SKETCH ON BACK

WETLAND SKETCH

C.C. Dorion

Line Flagging Series
1-7
8-17
CH-1 → 8

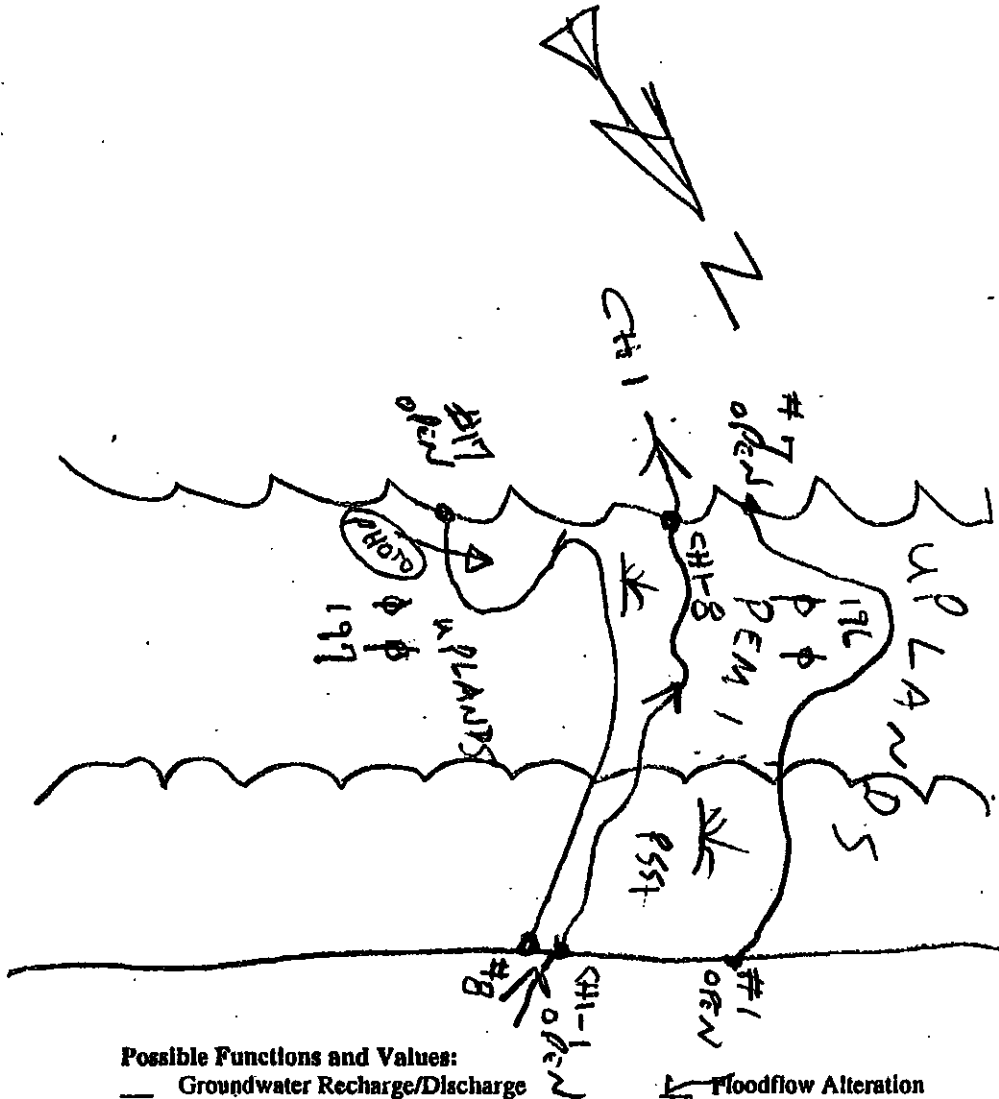

Possible Functions and Values:

- | | |
|---|---|
| <input type="checkbox"/> Groundwater Recharge/Discharge | <input checked="" type="checkbox"/> Floodflow Alteration |
| <input type="checkbox"/> Fish and Shellfish Habitat | <input checked="" type="checkbox"/> Sediment/Toxicant Retention |
| <input checked="" type="checkbox"/> Nutrient Removal | <input type="checkbox"/> Production Export |
| <input type="checkbox"/> Sediment/Shoreline Stabilization | <input checked="" type="checkbox"/> Wildlife Habitat |
| <input type="checkbox"/> Recreation | <input type="checkbox"/> Educational/Scientific Value |
| <input type="checkbox"/> Uniqueness/Heritage | <input type="checkbox"/> Visual Quality/Aesthetics |
| <input type="checkbox"/> Endangered Species Habitat | <input type="checkbox"/> Other |

Checklist:

- Wetland ID# A3-203-196-1
- North arrow.
- Detailed sketch of wetland boundary and flagging sequence.
- Natural and man-made features - roads, culverts, outcrops, structures, etc.
- Photo locations.
- Location of important wildlife sign.

A3-203-196-1-16

PROJECT TITLE: MRRP		TRANSECT:	PLOT: WETLAND			
DELINEATOR(S): CO, DPW		DATE: 8-22-07				
VEGETATION	Stratum and Species	Dominance Ratio	Percent Dominance	DOM	NWI Status	
SHrub:						
	<i>Cornus stolonifera</i>	30%				
	<i>Spiraea latifolia</i>	15				
	<i>Viburnum recognitum</i>	5				
	<i>Ilex verticillata</i>	10				
HERB:						
	<i>Calamagrostis canadensis</i>	80%				
	<i>Onoclea sensibilis</i>	30				
	<i>Eupatorium maculatum</i>	5%				
HYDROPHYTES			NON-HYDROPHYTES			
<u>OBL</u>	<u>FACW</u>	<u>FAC</u>	<u>OTHER</u>	<u>FAC</u>	<u>FACU</u>	<u>UPL</u>
Hydrophytes Subtotal (A): _____			Non-hydrophytes Subtotal (B): _____			
PERCENT HYDROPHYTES (100A/A+B): _____						
HYDROLOGY						
<input type="checkbox"/> RECORDED DATA						
Stream, lake, or tidal gauge		Identification: _____				
Aerial photography		Identification: _____				
Other		Identification: _____				
<input type="checkbox"/> NO RECORDED DATA						
<input checked="" type="checkbox"/> OBSERVATIONS:						
Depth to Free Water: <u>9 inches</u>						
Depth to Saturation (including capillary fringe): <u>AT SURFACE</u>						
Altered Hydrology (explain): <u>ROOTSLOPE OF OLD PASTURE</u>						
<input type="checkbox"/> Inundated	<input type="checkbox"/> Saturated in upper 12"	<input type="checkbox"/> Water Marks	<input type="checkbox"/> Drill Lines	<input type="checkbox"/> Sediment Deposits	<input checked="" type="checkbox"/> Drainage Patterns within Wetland	
<input checked="" type="checkbox"/> OTHER (explain): <u>HILLSIDE SEEPS</u>						

SOIL Sketch landscape position of this plot. Indicate relative position of other plot(s) and the wetland flag if not on plan.

Submission of photo of plot is encouraged.

DEPTH	HORIZON	MATRIX COLOR	REDOXIMORPHIC FEATURES (color, abundance, size, copres)	COMMENTS (USDA texture, nodules, concretions, masses, pore linings, restrictive layers, root distribution, soil water, etc.)
0-12"	Ap	10YR 3/2	ϕ	L, FR, GR ROOTS: C-M - F+M
12-22"	Bg	10YR 4/2	10YR 4/6 F, F, D	SL, FR, SBK ROOTS: F+W - FINE 15% GR
22-29" H	C	2.5Y 5/3	2.5Y 5/2 C, M, F	SL, FR, SBK 15% GR ROOTS: ϕ

HYDRIC SOIL INDICATOR(S): VII REFERENCE(S): Monarda 10am

OPTIONAL SOIL DATA REFERENCE(S):

Taxonomic subgroup: PD
Soil drainage class: 9 inches
Depth to active water table:
NTCHS hydric soil criterion:

CONCLUSIONS

	YES	NO	REMARKS:
Hydrophytic vegetation criterion met?	<input checked="" type="checkbox"/>	<input type="checkbox"/>	
Hydric soils criterion met?	<input checked="" type="checkbox"/>	<input type="checkbox"/>	
Wetland hydrology criterion met?	<input checked="" type="checkbox"/>	<input type="checkbox"/>	
IS THIS DATAPPOINT IN A WETLAND?	<input checked="" type="checkbox"/>	<input type="checkbox"/>	

PROJECT TITLE: MRP TRANSECT: PLOT: WETLAND

A3-203-F167-14

PROJECT TITLE: MRRP		TRANSECT: A3-203-176-1-16	PLOT: UPLAND	
DELINEATOR(S):		DATE: 8-22-07		
VEGETATION	Stratum and Species	Dominance Ratio	Percent Dominance	DOM
SHRUBS:				
	<i>Juniperus communis</i>		25%	
	<i>Corylus americana</i>		15%	
	<i>Spiraea latifolia</i>		5%	
HERBS:				
	<i>Poa pratensis</i>		5%	
	<i>Oxalis stricta</i>		5%	
	<i>Oxyclea sensibilis</i>			
	<i>Solidago rugosa</i>		20%	
			10%	
HYDROPHYTES		NON-HYDROPHYTES		
<u>OBL</u>	<u>FACW</u>	<u>FAC</u>	<u>*OTHER</u>	<u>FAC</u>
<u>FACU</u>	<u>UPL</u>			
Hydrophytes Subtotal (A): _____		Non-hydrophytes Subtotal (B): _____		
PERCENT HYDROPHYTES (100A/A+B): _____				
HYDROLOGY				
<input type="checkbox"/> RECORDED DATA				
Stream, lake, or tidal gage Identification: _____				
Aerial photography Identification: _____				
Other Identification: _____				
<input type="checkbox"/> NO RECORDED DATA				
<input checked="" type="checkbox"/> OBSERVATIONS:				
Depth to Free Water: <u>> 24 inches</u>				
Depth to Saturation (including capillary fringe): <u>19 inches</u>				
Altered Hydrology (explain): <u>FOOT SLOPE OF OLD PASTURE</u>				
<input type="checkbox"/>	<input type="checkbox"/>	<input type="checkbox"/>	<input type="checkbox"/>	<input type="checkbox"/>
Inundated	Saturated in upper 12"	Water Marks	Drift Lines	Sediment Deposits
<input type="checkbox"/>	<input type="checkbox"/> OTHER (explain):			
<input type="checkbox"/> Drainage Patterns within Wetland				

SOIL Sketch landscape position of this plot. Indicate relative position of other plot(s) and the wetland flag if not on plan.

Submission of photo of plot is encouraged.

DEPTH	HORIZON	MATRIX COLOR	REDOXIMORPHIC FEATURES (color, abundance, etc, contrast)	COMMENTS (USDA texture, nodules, concretions, masses, pore linings, restrictive layers, root distribution, soil water, etc.)
0-13"	Ap (FOOTSLUPE ON	10YR 3/2	φ OLD PAS	SL, FR, GR, 15% CB ROOTS: COMMON FINE TURB = DEPOSITION)
13-19	Bw	10YR 3/4	φ	SL, FR, SBK, 15% CB
19-24 in. +	Bc	10YR 4/5	7.5YR 4/4 F, F, D	SL, FR, SBK, 15% GR

HYDRIC SOIL INDICATOR(S): REFERENCE(S):

OPTIONAL SOIL DATA REFERENCE(S):

Taxonomic subgroup:
 Soil drainage class: **MWD**
 Depth to active water table: **> 24 inches**
 NCHS hydric soil criterion:

CONCLUSIONS

	YES	NO	REMARKS:
Hydrophytic vegetation criterion met?	<input type="checkbox"/>	<input checked="" type="checkbox"/>	
Hydro soils criterion met?	<input type="checkbox"/>	<input checked="" type="checkbox"/>	
Wetland hydrology criterion met?	<input type="checkbox"/>	<input checked="" type="checkbox"/>	
IS THIS DATAPoint IN A WETLAND?	<input type="checkbox"/>	<input checked="" type="checkbox"/>	

PROJECT TITLE: **MRRP** TRANSECT: **A3-203-196-1-** PLOT: **UPLAND**

Maine Power Reliability Project
WETLAND SUMMARY FORM

Team A

Observers: DWP, CCD, KTW Date: 8-21-07
Towp: Dixmont Series: 1-
Segment #: 3 CMP Section #: 203 CMP Pole #: 192 Wetland ID #: 1
Stream/Waterbody ID: A3-703-1921-CH1 Corps plot: Yes No

Dominant NWI Class: PSS1 Other NWI Classes:

SHrub: Representative Wetland Vegetation (by Strata): HERB:
Ilex vert.; Myrica Onoc. sens.; Eup. mac.
Vib. cass. gale Carex stricta
Vib. recg. Thalic. pub.
Alnus inc. Sol. gig.
Sparganium

Representative Wetland Hydrology

Permanently Flooded (approximate depth -) Seasonally Flooded (approximate depth - 2") Saturated

Hydrologic Indicators: Silt Deposition. Water-Stained Leaves
 Water Marks Drift Lines Surface Scouring
 Drainage Patterns Buttressed Trees Elevated Roots

Other Observations: STREAM FLOOD PLAIN

Representative Wetland Soils:
 Mineral
 Organic

Depth	Horizon	Color	Redox Features	Texture
0-6"	A1-MUCKY	10YR 2/2	Φ	MUCKY SILT
6-10	C	10YR 3/2	Φ	SAND
10-21"	A2-MUCKY	2.5Y 3/1	Φ	MUCKY SILT
@ 21"	BOULDERS	+ LEDGE		

Other Observations: Meets NEIWPCC (2004) Criteria VIII.A. ALLUVIAL SEQUENCE

Stream # 1 Data: 12 ft. NARROWS TO 4 ft.
Width (Bank-Bank): 12 ft. Depth @ Center: 6 in. Peren. Intermittent
Bank Configuration: Undercut Vertical Gradual
Channel Substrate: Peat-Muck Silt-Mud Sand Gravel/Cobble Boulder
 Bedrock

Stream # 2 Data
Width (Bank-Bank): _____ Depth @ Center: _____ Peren. _____ Intermittent _____
Bank Configuration: Undercut Vertical Gradual
Channel Substrate: Peat-Muck Silt-Mud Sand Gravel/Cobble Boulder
 Bedrock

Wildlife Observations/Sign (e.g., tracks/trails, droppings, dams/lodges, browse, dens, egg masses, potential VP):

Notes: FREE WATER @ 18 in. IN SOIL PRT

NRPA STREAM

Cedar Swamp

Wetland of Special Significance

Photo # 4

SKETCH ON BACK

WETLAND SKETCH

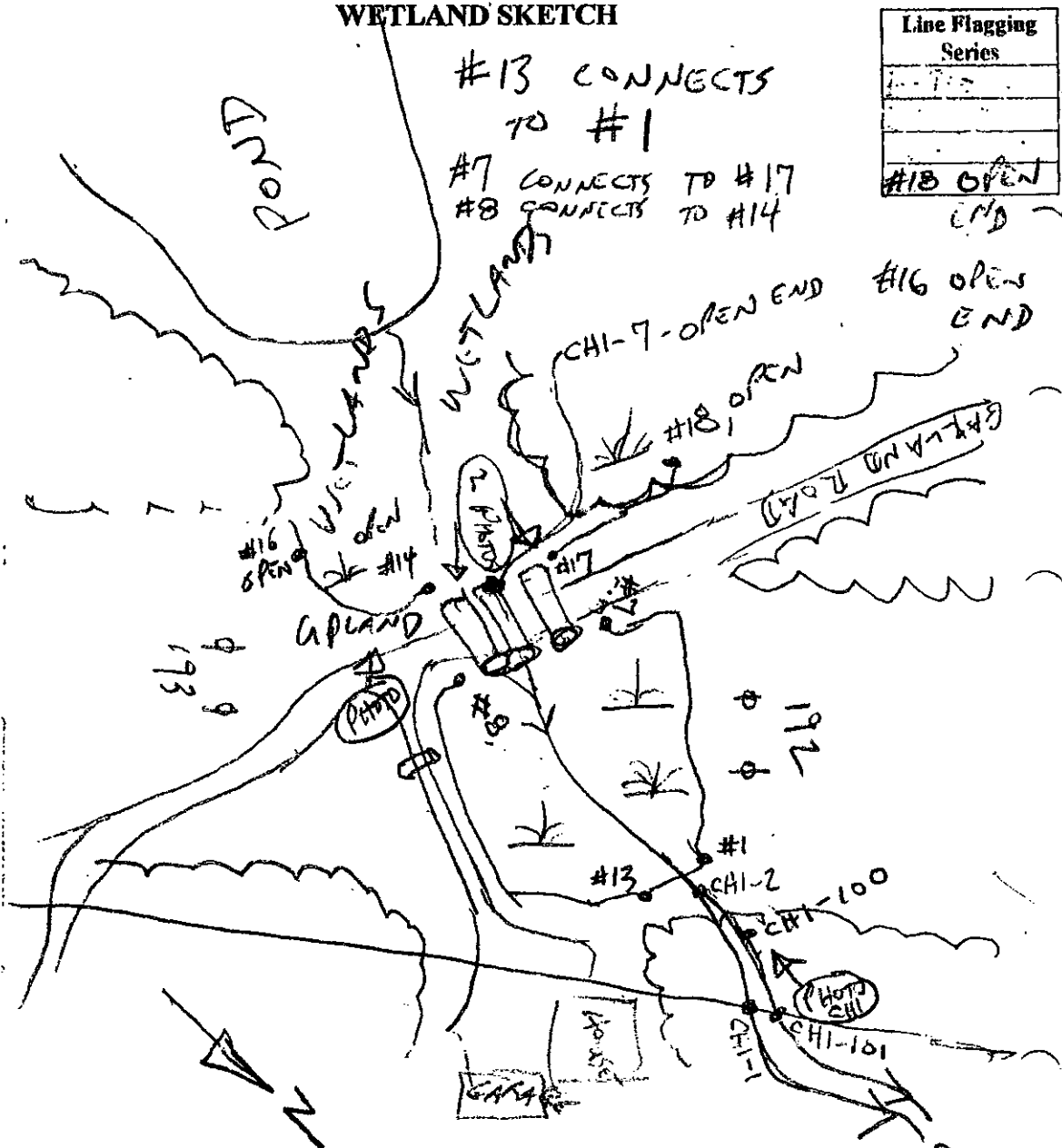

Line Flagging Series
#18 OPEN END

Possible Functions and Values:

- | | |
|--|---|
| <input type="checkbox"/> Groundwater Recharge/Discharge | <input checked="" type="checkbox"/> Floodflow Alteration |
| <input checked="" type="checkbox"/> Fish and Shellfish Habitat | <input checked="" type="checkbox"/> Sediment/Toxicant Retention |
| <input checked="" type="checkbox"/> Nutrient Removal | <input checked="" type="checkbox"/> Production Export |
| <input checked="" type="checkbox"/> Sediment/Shoreline Stabilization | <input checked="" type="checkbox"/> Wildlife Habitat |
| <input type="checkbox"/> Recreation | <input type="checkbox"/> Educational/Scientific Value |
| <input type="checkbox"/> Uniqueness/Heritage | <input checked="" type="checkbox"/> Visual Quality/Aesthetics |
| <input type="checkbox"/> Endangered Species Habitat | <input type="checkbox"/> Other |

Checklist:

- Wetland ID# A3-203-192-1
- North arrow.
- Detailed sketch of wetland boundary and flagging sequence.
- Natural and man-made features - roads, culverts, outcrops, structures, etc.
- Photo locations.
- Location of important wildlife sign.

Maine Power Reliability Project

Team A

WETLAND SUMMARY FORM

Observers: DWP, GGP, KJW Date: 8-21-07
Town: DIXMONT Series: 1
Segment #: 3 CMP Section #: 203 CMP Pole #: 192 Wetland ID #: 2
Stream/Waterbody ID: NONE Corps plot: Yes No

Dominant NWI Class: PSS1 Other NWI Classes: 1C1

Representative Wetland Vegetation (by Strata):

SHRUB: HERB:
Vib. cassin. Cal. can.
Vib. racem. Sul. lig.
Cornus stolon. Onoc. sens.

Representative Wetland Hydrology

Permanently Flooded (approximate depth -) Seasonally Flooded (approximate depth -) Saturated

Hydrologic Indicators: Silt Deposition Water-Stained Leaves
 Water Marks Drift Lines Surface Scouring
 Drainage Patterns Buttressed Trees Elevated Roots

Other Observations:

Representative Wetland Soils:
 Mineral
 Organic

Depth	Horizon	Color	Redox Features	Texture
0-12"	A1-MUCKY	10YR 5/2	G, M, D	MUCKY SL
12-16	A2-MUCKY	10YR 3/1	G, F, P	SL
16-20"+	Cg	2.5Y 4/2	G, C, F	SL

Other Observations: Meets NEIWPCC (2004) Criteria II RE-GRADED AREA

Stream # 1 Data:
Width (Bank-Bank): _____ Depth @ Center: _____ Peren. _____ Intermittent _____
Bank Configuration: _____ Undercut _____ Vertical _____ Gradual _____
Channel Substrate: _____ Peat-Muck _____ Silt-Mud _____ Sand _____ Gravel/Cobble _____ Boulder _____ Bedrock _____

Stream # 2 Data:
Width (Bank-Bank): _____ Depth @ Center: _____ Peren. _____ Intermittent _____
Bank Configuration: _____ Undercut _____ Vertical _____ Gradual _____
Channel Substrate: _____ Peat-Muck _____ Silt-Mud _____ Sand _____ Gravel/Cobble _____ Boulder _____ Bedrock _____

Wildlife Observations/Sign (e.g., tracks/trails, droppings, dams/lodges, browse, dens, egg masses, potential VP):

Notes:

Cedar Swamp

Wetland of Special Significance

Photo # 1

SKETCH ON BACK

WETLAND SKETCH

Line Flagging Series
1-5

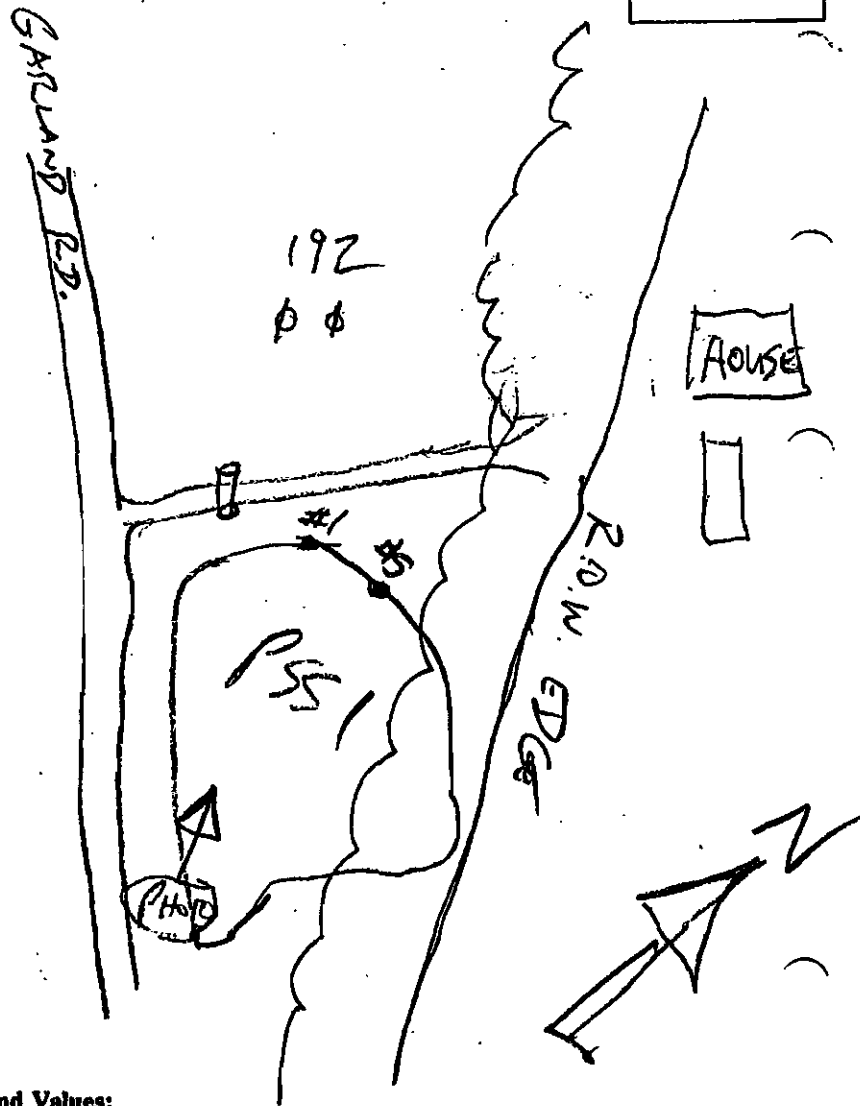

Possible Functions and Values:

- | | |
|---|---|
| <input type="checkbox"/> Groundwater Recharge/Discharge | <input type="checkbox"/> Floodflow Alteration |
| <input type="checkbox"/> Fish and Shellfish Habitat | <input type="checkbox"/> Sediment/Toxicant Retention |
| <input type="checkbox"/> Nutrient Removal | <input type="checkbox"/> Production Export |
| <input type="checkbox"/> Sediment/Shoreline Stabilization | <input type="checkbox"/> Wildlife Habitat |
| <input type="checkbox"/> Recreation | <input type="checkbox"/> Educational/Scientific Value |
| <input type="checkbox"/> Uniqueness/Heritage | <input type="checkbox"/> Visual Quality/Aesthetics |
| <input type="checkbox"/> Endangered Species Habitat | <input type="checkbox"/> Other |

Checklist:

- Wetland ID# 43-203-192-2
- North arrow.
- Detailed sketch of wetland boundary and flagging sequence.
- Natural and man-made features -- roads, culverts, outcrops, structures, etc.
- Photo locations.
- Location of important wildlife sign.